

Fluorescence Immunoassay Analyzer AFR-901

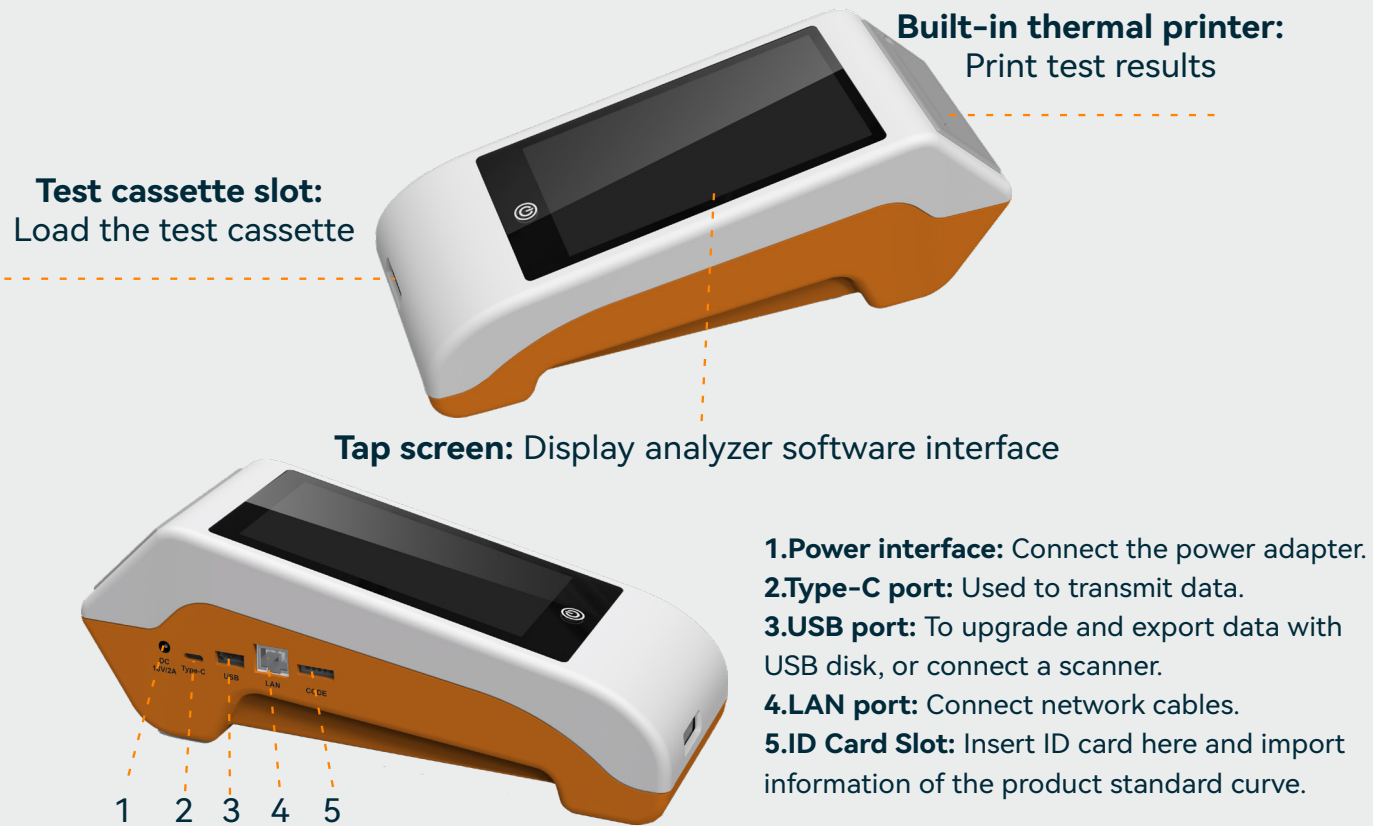

FIATEST PRO Fluorescence Immunoassay Analyzer - AFR-901

- High Accuracy (Stringent Quality Control Monitoring & System Check Function)
- User-Friendly (Simple Plug & Play Operation)
- Easy Operation (Less Training Required)
- Suitable for Emergency Applications and Ambulance (Built-in Battery, Portable, Lightweight , Small Size and Easy Operation)
- Time- saving (Reading Time less than 20 Seconds)
- LIS Compatibility Available
- Strong Stability
- Extensive Test Menu
- LCD Screen (5-inch Color Page Touch Screen)
- Provide Customized Services (Language, Appearance and Style)

Technical Specifications

Parameter	Description
Principle	Fluorescence Immunoassay
Test formats	Cassette
Measurement	Quantitative, Qualitative
Read Time	< 20 seconds
Dimension	275mm*105mm*100mm (L*W*H)
Screen size	5 inches
Weight	1kg
Spectrum	Excitation spectrum: Mean wavelength $\lambda_0=365\text{nm}$ Reception spectrum: Mean wavelength $\lambda_1=610\text{nm}$
Memory	10000 records
Printer	Built-in thermal printer
Ports	LAN×1, USB×1, Type-Cx1

Product Advantages

- ✓ Powered by Europium-based Technology for High Quality
- ✓ Fast Result (3-15 minutes)
- ✓ Simple Operation (Less Training Required)
- ✓ Objective (Results Read by Analyzer)
- ✓ Stringent Quality Control Insure High Accuracy
- ✓ Easy Storage Condition (4-30°C) with 2 Years Shelf Life



Test Menu

Cat. No.	Product	Specimen	Cut-off	Measuring Range	Pack	CE status
Inflammation Marker						
FI-CRP-402	CRP	WB/S/P	hsCRP: 1 mg/L, CRP: 10 mg/L	0.5-200 mg/L	10T/25T	CE
FI-PCT-402	PCT	WB/S/P	0.5 ng/mL	0.1-50 ng/mL	10T/25T	CE
FI-IL6-402	IL-6	WB/S/P	10 pg/mL	3.0-5000 pg/mL	10T/25T	CE
FI-SAA-402	SAA	WB/S/P	10 mg/L	1-300 mg/L	10T/25T	CE
Tumor Marker						
FI-PSA-302	PSA	S/P	4 ng/mL	2-100 ng/mL	10T/25T	Non-CE
FI-PSA-402	PSA	WB/S/P	4 ng/mL	2-100 ng/mL	10T/25T	Non-CE
FI-FPSA-302	Free PSA	S/P	/	0.1-30 ng/mL	10T/25T	Non-CE
FI-AFP-302	AFP	S/P	20 ng/mL	5-400 ng/mL	10T/25T	CE
FI-CEA-302	CEA	S/P	4 ng/mL	1-500 ng/mL	10T/25T	CE
FI-FOB-602	FOB	Feces	50 ng/mL	10-1000 ng/mL	10T/25T	CE
* FI-CA211-402	CYFRA21-1	WB/S/P	<3.3 ng/mL	1-300ng/mL	10T/25T	CE
Cardiac Marker						
FI-CTI-402	cTnI	WB/S/P	0.5 ng/mL	0.1-40 ng/mL	10T/25T	CE
FI-CTNT-402	cTnT	WB/S/P	0.5 ng/mL	0.2-40 ng/mL	10T/25T	CE
FI-NBNP-402	NT-proBNP	WB/S/P	0.45 ng/mL	0.3-22 ng/mL	10T/25T	CE
FI-CKMB-402	CK-MB	WB/S/P	5 ng/mL	0.2-75 ng/mL	10T/25T	CE
FI-HFA-402	H-FABP	WB/S/P	8 ng/mL	1-120 ng/mL	10T/25T	CE
FI-MYO-402	Myoglobin	WB/S/P	90 ng/mL	5-200 ng/mL	10T/25T	CE
FI-AMI-435	Troponin I/Myoglobin/ CK-MB (3 in 1)	WB/S/P	cTnI: 0.5 ng/mL MYO: 90 ng/mL CK-MB: 5 ng/mL	0.1-40 ng/mL 5-200 ng/mL 0.2-75 ng/mL	10T/25T	CE
* FI-AMIT-435	Troponin T/ Myoglobin/ CK-MB Combo (3 in 1)	WB/S/P	cTnT:0.2 ng/mL MYO: 90 ng/mL CK-MB: 5 ng/mL	0.1-40 ng/mL 5-200 ng/mL 0.2-75 ng/mL	10T/25T	CE
FI-CPC-435	Troponin I/NT-proBNP/ D-Dimer Combo (3 in 1)	WB/S/P	cTnI: 0.5 ng/mL D-Dimer: 0.5mg/L NT-proBNP: 0.45 ng/mL	0.1-40 ng/mL 0.1-10mg/L 0.3-22 ng/mL	10T/25T	CE
Coagulation						
FI-DDM-402	D-Dimer	WB/P	0.5 mg/L	0.1-10 mg/L	10T/25T	CE
Endocrinology						
FI-FSH-402	FSH	WB/S/P	/	1-100 mIU/mL	10T/25T	CE
FI-LH-402	LH	WB/S/P	/	1-300 mIU/mL	10T/25T	CE
FI-T3-302	T3	S/P	1.23-3.08 nmol/L	0.62-9.24 nmol/L	10T/25T	CE
* FI-T3-402	T3	WB/S/P	1.23-3.08nmol/L	0.62-9.24 nmol/L	10T/25T	CE
FI-FT3-302	FT3	S/P	2.6-5.7 pmol/L	1.5-46 pmol/L	10T/25T	CE
* FI-FT3-402	FT3	WB/S/P	2.6-5.7 pmol/L	1.5-46 pmol/L	10T/25T	CE
FI-T4-302	T4	S/P	65-155 nmol/L	12.87-300 nmol/L	10T/25T	CE
* FI-T4-402	T4	WB/S/P	65-155nmol/L	12.87-300 nmol/L	10T/25T	CE
FI-FT4-302	FT4	S/P	6.7-16.4 pmol/L	1-100 pmol/L	10T/25T	CE
* FI-FT4-402	FT4	WB/S/P	6.7-16.4pmol/L	1-100 pmo/L.	10T/25T	CE
FI-TES-302	Testosterone	S/P	"Female:0-2 ng/mL, Male:2.6-12 ng/mL"	1.0-20 ng/mL	10T/25T	CE
FI-BHCG-302	β-HCG	S/P	25 mIU/mL	5-10,000 mIU/mL	10T/25T	CE
FI-BHCG-402	β-hCG	WB/S/P	5 mIU/mL	2-200,000 mIU/mL	10T/25T	CE
FI-P4-302	Progesterone (P4)	S/P	/	1.4-60 ng/mL	10T/25T	CE
FI-FER-302	Ferritin	S/P	Male:30-400 ng/mL, Female:13-150 ng/mL	1.0-500.0 ng/mL	10T/25T	CE
FI-TSH-302	TSH	S/P	0.5-5 μIU/mL	0.1-100 μIU/mL	10T/25T	CE
FI-PRL-402	PRL	WB/S/P	"Female (Non-pregnant): 2- 25 ng/mL Female (Pregnant): 10 - 209 ng/mL Male:2 - 18 ng/mL"	1.0 - 200 ng/mL	10T/25T	CE
FI-AMH-402	AMH	WB/S/P	/	0.05-25 ng/mL	10T/25T	CE
FI-COR-302	Cortisol	S/P	140 - 690 nmol/L	50 nmol/L - 1000 nmol/L	10T/25T	CE

Cat. No.	Product	Specimen	Cut-off	Measuring Range	Pack	CE status
Nephrology						
FI-ALB-102	mAlb	Urine	20 mg/L	5-300 mg/L	10T/25T	CE
FI-CYSC-402	CysC	WB/S/P	1.1 mg/L	0.1-9.0 mg/L	10T/25T	CE
FI-BMG-402	β2MG	WB/S/P	2.2 mg/L	0.2-20 mg/L	10T/25T	CE
FI-NGAL-102	N-GAL	Urine	10 ng/mL	10-1500 ng/mL	10T/25T	CE
Diabetes						
FI-HBA-402	HbA1c	WB	4-6%	4-14.5%	10T/25T	CE
Infectious Diseases						
FI-STA-502	Strep A	Swab	/	Qualitative	10T/20T	CE
FI-FLU-502	FLU A+B	Swab	/	Qualitative	10T/20T	CE
FI-RSV-502	RSV	Swab	/	Qualitative	10T/20T	CE
FI-NCP-502	COVID-19 Antigen	Swab	/	Qualitative	20T	CE
FI-DEN-402	Dengue IgG/IgM	WB/S/P	/	Qualitative	10T/25T	CE
FI-DES-402	Dengue NS1	WB/S/P	/	Qualitative	10T/25T	CE
FI-NCP-402	COVID-19 IgG/IgM	WB/S/P	/	Qualitative	10T/25T	CE
FI-CSG-402	COVID-19 S-RBD IgG Antibody	WB/S/P	/	Semi-quantitative	10T/25T	CE
FI-CIC-525	COVID-19 Ag/FLU A+B Combo	NP Swab	/	Qualitative	20T	CE
FI-SYP-402	Syphilis Antibody	WB/S/P	/	Qualitative	10T/25T	CE
* FI-SP-102	Streptococcus pneumoniae	Urine	/	Qualitative	10T/25T	CE
* FI-LEG-102	Legionella pneumophila Antigen	Urine	/	Qualitative	10T/25T	CE
* FI-CSG-402B	COVID-19 S-RBD IgG Quantitative	WB/S/P	/	Qualitative	10T/25T	CE
FI-HP-602	H. pylori Antigen	Feces	< 2.5 ng/mL	2-1500 ng/mL	10T/25T	CE
FI-MAL-435	Malaria P.f./P.v./Pan Antigen	WB	/	Qualitative	10T/25T	CE
* FI-TYP-402	Typhoid Antibody	WB/S/P	/	Qualitative	10T/25T	CE
* FI-TET-402	Tetanus Antibody	WB/S/P	0.1 IU/mL	0.05-10 IU/mL	10T/25T	CE
* FI-ROT-602	Rotavirus Antigen	Feces	/	Qualitative	10T/25T	CE
* FI-HBSG-402	HBsAg Antigen	WB/S/P	<0.5 IU/mL	0.5-200 IU/mL	10T/25T	Non-CE
FI-HBSB-402	HBsAb Antibody	WB/S/P	< 10mIU/mL	5-1000 mIU/mL	10T/25T	Non-CE
FI-HCV-402	HCV Antibody	WB/S/P	/	Qualitative	10T/25T	Non-CE
* FI-MXG-402	Monkeypox Virus Antigen	/	/	Qualitative	20T	CE
FI-HIV-402	HIV1/2 Antibody	WB/S/P	/	Qualitative	10T/25T	Non-CE
* FI-HIG-402	HIV P24 Antigen	WB/S/P	/	Qualitative	10T/25T	Non-CE
* FI-ASO-302	Anti-streptolysin O (ASO)	S/P	"Adults: < 200 IU/mL; Children: <250 IU/mL"	25-800 IU/mL	10T/25T	CE
Autoimmunity						
FI-IGE-402	IgE	WB/S/P	100 IU/mL	20-1600 IU/mL	10T/25T	CE
* FI-IGA-402	IgA	WB/S/P	0.7-4.3 g/L	0.1-7.0g/L	10T/25T	CE
* FI-RFM-402	Rheumatoid Factor(RF) IgM	WB/S/P	20IU/mL	8-200 IU/mL	10T/25T	CE
Others						
FI-CAL-602	Calprotectin	Feces	20 μg/g	1-1000 μg/g	10T/25T	CE
FI-VD-302	Vitamin D	S/P	>30 ng/mL	5-100 ng/mL	10T/25T	CE
Drugs of Abuse						
* FI-MET-102	MET	Urine	1000 ng/mL	100-5000 ng/mL	10T/25T	CE
* FI-MOP-102	MOP	Urine	/	Quantitative	10T/25T	CE
* FI-COC-102	COC	Urine	300 ng/mL	50-3000 ng/mL	10T/25T	CE
* FI-AMP-102	AMP	Urine	1000 ng/mL	300-3000 ng/mL	10T/25T	CE
* FI-BZO-102	BZO	Urine	300 ng/mL	150-1500 ng/mL	10T/25T	CE
* FI-APVP-102	APVP	Urine	/	Quantitative	10T/25T	CE
* FI-BAR-102	BAR	Urine	300 ng/mL	50-1200 ng/mL	10T/25T	CE
* FI-THC-102	THC	Urine	50 ng/mL	25-150 ng/mL	10T/25T	CE
* FI-MDMA-102	MDMA	Urine	/	Quantitative	10T/25T	CE
* FI-MTD-102	MTD	Urine	300 ng/mL	150-1500 ng/mL	10T/25T	CE
* FI-PCP-102	PCP	Urine	/	Quantitative	10T/25T	CE
* FI-OPI-102	OPI	Urine	2000 ng/mL	300-6000 ng/mL	10T/25T	CE

* NEW Product
Products marked in purple : Fingerstick Whole Blood Specimen Available